

Roofs

Designed to fit the trapezoidal spaces in roof and wall cladding profiles.

Description

Intuprofile sections are factory cut from dense mineral fibre to suit trapezoidal flutes or dovetails and are produced oversized to ensure a snug fit.

Firetherm require either the steel decking manufacturer's reference or the site-measured dimensions (height, width at top and width at bottom).

Sizes and Colours

Size: bespoke to decking profile

Colour: light brown. Can be painted or covered with acrylic mastic for aesthetic, acoustic and fibre migration reasons

Density: 70 kg nominal uncoated

Fire Testing

- Tested at Warrington Fire Research to BS 476 Pt 22: 2 hour fire integrity: 1 hr fire protection 75 mm deep 2 hrs fire protection 100 mm deep

Features

- Highly economic solution
- Smoke and fire resistant
- Halogen free
- Excellent acoustics: 48 dB uncoated, 64 dB coated using 2 mm Intumastic trowel grade or bonding cement

Applications

Used to seal trapezoidal openings against the passage of fire where profiled steel floor decking abuts the heads of fire compartment walls or where profiled wall sheeting abuts the edge of a floor slab.

Can provide up to 2 hours integrity and insulation depending on specification.

Installation

- 1) Locate and read Intuprofile safety data sheet.
- 2) Remove carefully from packaging and check the size and shape of the delivered Intuprofile suits the cavity to be filled with a trial fit.
- 3) Intuprofile is made slightly oversized to be fitted under compression. Gently squeeze with finger pressure and insert into cavity.
- 4) Finish the seal flush with the face of the opening.
- 5) Inspect completed work for poor fit and make good as necessary using additional material or coating.

For butterfly infills, use Intumastic.

Legislation

Fire stopping is required by Building Regulation 2000, Approved Document B Intuprofile has been tested in accordance with the requirements of BS 476 Pt 22.

Typical Details

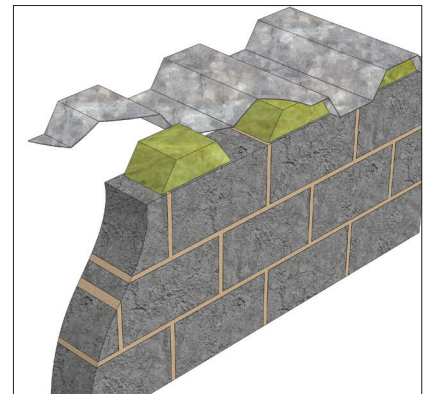

Blockwork wall with Intuprofile

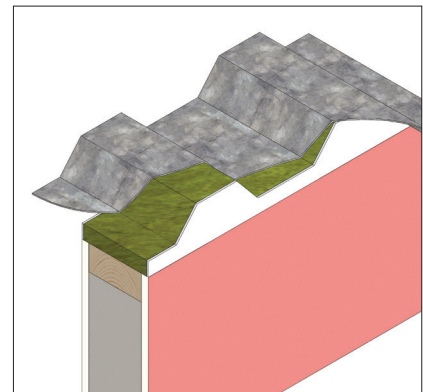

Dry lined wall with Intuprofile