



Walls

Floors

Use to bond structural steel and ductwork protection boards in internal situations.

Description

Intutac is a sodium silicate adhesive of buttery consistency that dries to form non-combustible film to BS 476 Part 4: 1970. Supplied in a 10 litre tub.

Specifications

Colour: off white

Form: heavy paste

Weight per litre: 1.7 kg approx.

Composition: sodium silicate base with inert fillers

Packaging: 17 kg poly-buckets

Shelf life/storage: 12 months from date of manufacture. Store unopened in a cool, dry place between 6°C and 30°C out of direct sunlight. Protect from frost.

Fire Testing

- Tested in conjunction with Firetherm Intutec and Intuduct systems

Features

- Water resistant seal
- Unaffected by moisture

Applications

Intutac is an adhesive for use in fire protection to bond Firetherm Intutec (structural steel protection) and Intuduct (ductwork protection) boards in internal situations.

Installation

1. Read Intutac safety data sheet before starting work.
2. Surfaces should be clean and dry, free of dust, grease and loose material.
3. Stir Intutac thoroughly and apply evenly over the surface to be bonded using a brush or flat bladed tool at a rate of 2.5 m² per litre.
4. Join Intutec or Intuduct boards within 2 to 3 minutes. Intutac does not have strong initial tack and boards may require some additional support during the curing process.

Drying time: bond time 0 to 5 minutes

Full cure: 8 to 12 hours

Coverage: 2.5 m²/l

Typical Details

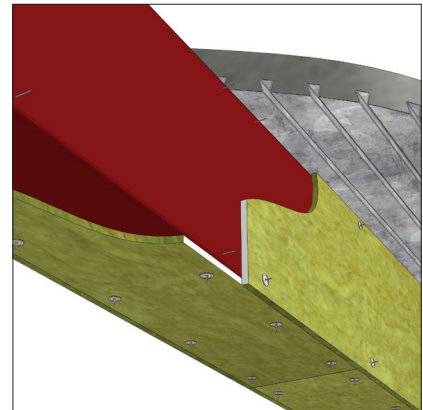

Encased steel

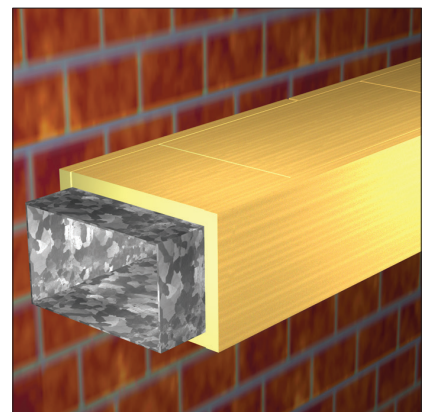

Intuduct

Firetherm Intumescent & Insulation Supplies Limited
Unit F Acorn Industrial Park, Crayford Road, Crayford, Kent DA1 4FT
Phone: 01322 551010 Fax: 01322 552727 Email: sales@firetherm.com www.firetherm.com

